

\$209,900 - 2063 Spruce Cres, Rural Parkland County

MLS® #E4422858

\$209,900

0 Bedroom, 0.00 Bathroom,
Rural on 0.50 Acres

Spring Lake Ranch, Rural Parkland County,
AB

Price will increase on April 22 Located on Spruce Cres, Lot #35 SPRING MIST is a beautiful & private property with mature trees on a pie shaped lot. With a west facing backyard & quiet cul-de-sac location, this property offers residents a gorgeous & peaceful retreat. This is the only lot that offers a grand-fathered well, perfect for watering your outdoor landscaping & garden-this is a HUGE benefit. Enjoy summer at the lake, canoe, fish, stand up paddle boarding, swim & kayak. In the winter, the frozen lake offers a plethora of activities such as ice fishing, snow shoeing, & skating. Enjoy walks through the trail system all year round. The community of Spring Lake offers several playgrounds, skating rink/basketball/pickle ball court. You will love the community events: fall festival, Christmas contests, drive in movies. 12 Min to Stony Plain, 25 to Edmonton, 5 min to Blueberry School. Property borders are for illustration purposes & do not show official survey lines. GST will be added on top of price

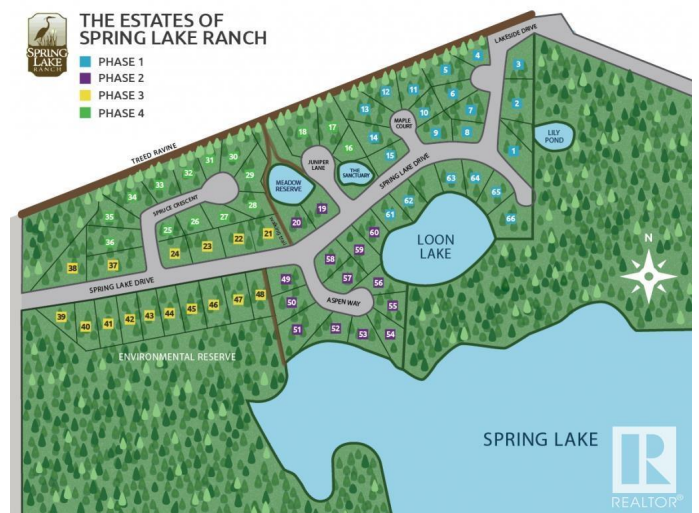
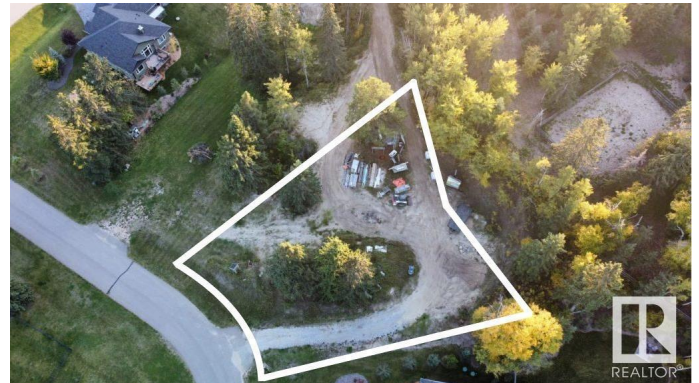

Essential Information

MLS® #	E4422858
Price	\$209,900
Bathrooms	0.00

Acres	0.50
Type	Rural
Sub-Type	Vacant Lot/Land
Status	Active

Community Information

Address	2063 Spruce Cres
Area	Rural Parkland County
Subdivision	Spring Lake Ranch
City	Rural Parkland County
County	ALBERTA
Province	AB
Postal Code	T7Z 2V3

Exterior

Exterior Features	Backs Onto Park/Trees, Corner Lot, Flat Site, Lake Access Property, Picnic Area, Playground Nearby, Schools, Treed Lot
-------------------	--

Additional Information

Date Listed	February 25th, 2025
Days on Market	70
Zoning	Zone 94

DATA IS DEEMED RELIABLE BUT IS NOT GUARANTEED ACCURATE BY THE REALTORS® ASSOCIATION OF EDMONTON. COPYRIGHT 2025 BY THE REALTORS® ASSOCIATION OF EDMONTON. ALL RIGHTS RESERVED. Trademarks are owned or controlled by the Canadian Real Estate Association (CREA) and identify real estate professionals who are members of CREA (REALTOR®, REALTORS®) and/or the quality of services they provide (MLS®, Multiple Listing Service®)

Listing information last updated on May 5th, 2025 at 11:17pm MDT