

\$429,900

Leger, Edmonton, AB

A photograph showing the exterior of a modern multi-story building. The building features a mix of stone cladding and large glass windows. In the foreground, there is a black metal railing and a paved area with a blue 'S' sign. The building has a prominent entrance area with a stone-clad facade and a sign that reads 'THE ASHLEY'. The surrounding area is landscaped with trees and shrubs.

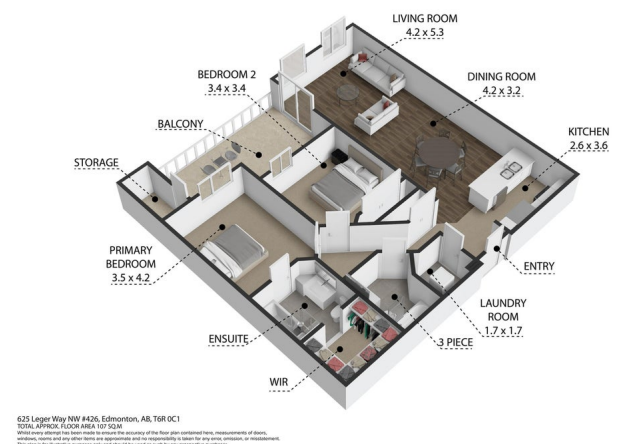

625 Leger Way NW #426, Edmonton, AB, T6R 0C1
TOTAL APPROX. FLOOR AREA 107 SQ.M
Whilst every attempt has been made to ensure the accuracy of the floor plan contained here, measurements of doors, windows, rooms and any other items are approximate and no responsibility is taken for any error, omission, or misstatement.

Essential Information

| | |
|----------|-----------|
| MLS® # | E4442595 |
| Price | \$429,900 |
| Bedrooms | 2 |

| | |
|----------------|------------------------|
| Bathrooms | 2.00 |
| Full Baths | 2 |
| Square Footage | 1,154 |
| Acres | 0.00 |
| Year Built | 2015 |
| Type | Condo / Townhouse |
| Sub-Type | Lowrise Apartment |
| Style | Single Level Apartment |
| Status | Active |

Community Information

| | |
|-------------|-------------------|
| Address | 413 625 Leger Way |
| Area | Edmonton |
| Subdivision | Leger |
| City | Edmonton |
| County | ALBERTA |
| Province | AB |
| Postal Code | T6R 0W4 |

Amenities

| | |
|----------------|--------------------------------|
| Amenities | Secured Parking, Security Door |
| Parking Spaces | 2 |
| Parking | Tandem, Underground |

Interior

| | |
|-------------------|--------------------------------------------------------------------------------------------------|
| Interior Features | ensuite bathroom |
| Appliances | Air Conditioning-Central, Dishwasher-Built-In, Dryer, Microwave Hood Fan, Stove-Electric, Washer |
| Heating | Forced Air-1, Natural Gas |
| # of Stories | 4 |
| Stories | 1 |
| Has Basement | Yes |
| Basement | None, No Basement |

Exterior

| | |
|-------------------|------------------------------------------------------------------------------------------------------------------------------|
| Exterior | Wood, Stone, Stucco |
| Exterior Features | Landscaped, Public Swimming Pool, Public Transportation, Schools, Shopping Nearby, Ski Hill Nearby, View City, View Downtown |
| Roof | Tar & Gravel |

| | |
|--------------|---------------------|
| Construction | Wood, Stone, Stucco |
| Foundation | Concrete Perimeter |

Additional Information

| | |
|----------------|-----------------|
| Date Listed | June 16th, 2025 |
| Days on Market | 15 |
| Zoning | Zone 14 |
| Condo Fee | \$413 |

DATA IS DEEMED RELIABLE BUT IS NOT GUARANTEED ACCURATE BY THE REALTORS® ASSOCIATION OF EDMONTON. COPYRIGHT 2025 BY THE REALTORS® ASSOCIATION OF EDMONTON. ALL RIGHTS RESERVED.Trademarks are owned or controlled by the Canadian Real Estate Association (CREA) and identify real estate professionals who are members of CREA (REALTOR®, REALTORS®) and/or the quality of services they provide (MLS®, Multiple Listing Service®)

Listing information last updated on July 1st, 2025 at 4:47pm MDT