

# \$637,250 - 8619 181 Avenue, Edmonton

MLS® #E4453529

**\$637,250**

4 Bedroom, 4.00 Bathroom, 2,270 sqft

Single Family on 0.00 Acres

Klarvatten, Edmonton, AB

The Artemis offers 2270sqft of well-planned living space in a 4-bedroom layout that blends modern style with everyday comfort. Highlights include a double attached garage, 9' ceilings on the main & basement levels, LVP flooring, and SLD recessed lighting throughout. The foyer opens to a sitting room, a main floor bedroom, and a 3pc bath with standing shower. A mudroom with open closet links the garage to the kitchen through a walk-through pantry. The open-concept layout connects the sitting room, nook, great room, and kitchen, featuring quartz counters, a flush island, undermount sink with Moen pull-down faucet, backsplash, OTR microwave, pendant lighting, and plentiful soft-close cabinetry. A soaring 17' ceiling in the great room plus large windows & a garden door create a bright, airy feel. Upstairs includes 2 primary suites with 4pc ensuites & walk-in closets, plus a bonus room, laundry, main bath, and another bedroom. Basement rough-ins & Sterlingâ€™s Signature Specification complete this home.

Built in 2025

## Essential Information

MLS® # E4453529

Price \$637,250

Bedrooms 4

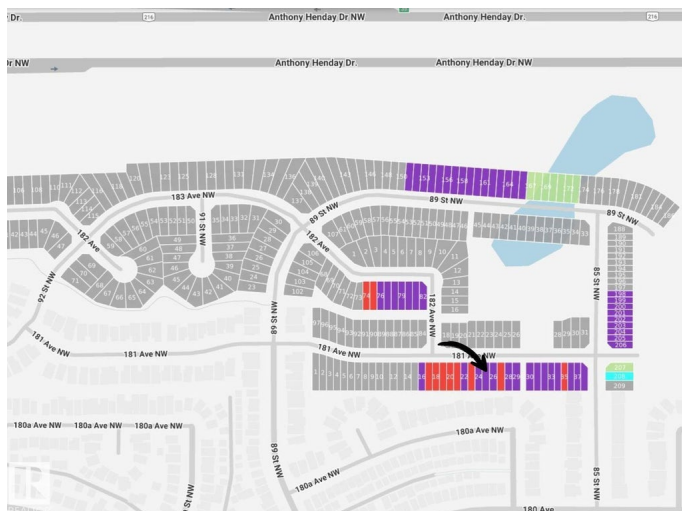

Bathrooms	4.00
Full Baths	4
Square Footage	2,270
Acres	0.00
Year Built	2025
Type	Single Family
Sub-Type	Detached Single Family
Style	2 Storey
Status	Active

### Community Information

Address	8619 181 Avenue
Area	Edmonton
Subdivision	Klarvatten
City	Edmonton
County	ALBERTA
Province	AB
Postal Code	T5Z 0X2

### Amenities

Amenities	Ceiling 9 ft., Detectors Smoke, No Animal Home, No Smoking Home, Smart/Program. Thermostat, Television Connection, 9 ft. Basement Ceiling
Parking	Double Garage Attached

### Interior

Interior Features	ensuite bathroom
Appliances	Garage Control, Garage Opener, None
Heating	Forced Air-1, Natural Gas
Stories	2
Has Basement	Yes
Basement	Full, Unfinished

### Exterior

Exterior	Wood, Vinyl
Exterior Features	No Through Road, Playground Nearby, Public Transportation, Schools, Shopping Nearby
Roof	Asphalt Shingles
Construction	Wood, Vinyl

Foundation                      Concrete Perimeter

The Artemis | 2,270 Sq. Ft.

Additional Information

Date Listed                      August 18th, 2025  
Days on Market                1  
Zoning                              Zone 28



DATA IS DEEMED RELIABLE BUT IS NOT GUARANTEED ACCURATE BY THE REALTORS® ASSOCIATION OF EDMONTON. COPYRIGHT 2025 BY THE REALTORS® ASSOCIATION OF EDMONTON. ALL RIGHTS RESERVED.Trademarks are owned or controlled by the Canadian Real Estate Association (CREA) and identify real estate professionals who are members of CREA (REALTOR®, REALTORS®) and/or the quality of services they provide (MLS®, Multiple Listing Service®)  
Listing information last updated on August 19th, 2025 at 4:32am MDT