

\$1,100,000 - Ne-9-52-2-5, Rural Parkland County

MLS® #E4458478

\$1,100,000

0 Bedroom, 0.00 Bathroom,
Rural on 129.46 Acres

None, Rural Parkland County, AB

Pre Approved Subdivision and Certified Organic! Here's your opportunity to continue the development of the prestigious community of West Point Estates by Jackfish Lake. Bordering HWY 770 and TWP RD 522 this 129 acres of gentle sloping land is nestled up to the East side of the existing West Point Estates community you have 129 acres with a great mix of trees and open spaces with all the opportunities at your fingertips. Just a quick 15 min drive west from Stony Plain/Spruce Grove all on pavement with quick access to commuter roads to Edmonton. The heavy lifting has been completed w/ the county with plans available. A developers dream to complete the vision and to complete a community that families will love for a lifetime.

Essential Information

MLS® #	E4458478
Price	\$1,100,000
Bathrooms	0.00
Acres	129.46
Type	Rural
Sub-Type	Vacant Lot/Land
Status	Active

Community Information

Address Ne-9-52-2-5

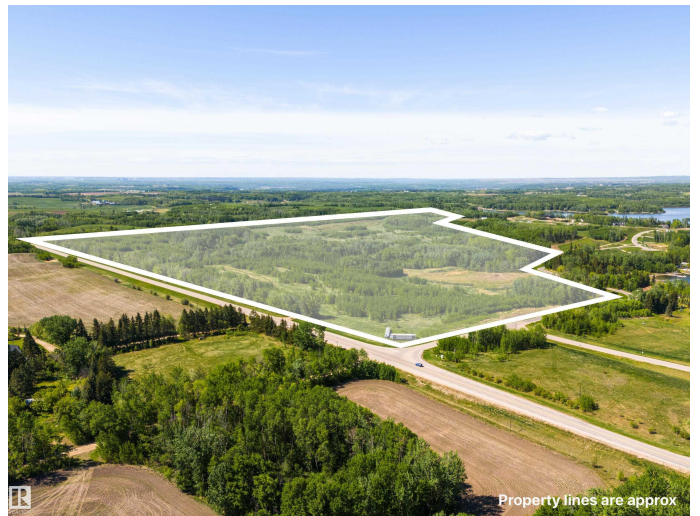

Area	Rural Parkland County
Subdivision	None
City	Rural Parkland County
County	ALBERTA
Province	AB
Postal Code	T7Y 3L7

Exterior

Exterior Features Corner Lot, Lake View, Private Setting, Rolling Land

Additional Information

Date Listed	September 18th, 2025
Days on Market	2
Zoning	Zone 90

DATA IS DEEMED RELIABLE BUT IS NOT GUARANTEED ACCURATE BY THE REALTORS® ASSOCIATION OF EDMONTON. COPYRIGHT 2025 BY THE REALTORS® ASSOCIATION OF EDMONTON. ALL RIGHTS RESERVED. Trademarks are owned or controlled by the Canadian Real Estate Association (CREA) and identify real estate professionals who are members of CREA (REALTOR®, REALTORS®) and/or the quality of services they provide (MLS®, Multiple Listing Service®)

Listing information last updated on September 20th, 2025 at 5:17pm MDT